

DIGITAL METER AND PULSER



FOR OIL AND ALLIED PRODUCTS

Flow rate **35/70/100** l/min



FOR DIESEL FUEL

Flow rate **90/120** l/min



FOR ANTIFREEZE AND WINDSHIELD WASHING LIQUID

Flow rate **40** l/min

 **ECODORA**

CE Made in Italy



ECODORA's digital meters, besides gauging the liquid delivered, can show instant flow rates, provide a reset total and allow the setting of different units of measurement. RAASM's digital meters are suitable for a wide variety of fluids, from low to medium to high viscosities, including lubricants, diesel fuel, antifreeze, window wash liquid and other fluids compatible with the material of the meter.

Flow rate **35** l/min



Flow rate **70** l/min



Flow rate **100** l/min



for **OIL AND ALLIED PRODUCTS**

for **OIL AND ALLIED PRODUCTS**

for **OIL AND ALLIED PRODUCTS**

Not type-approved for public use

Article	Art. OE37780	Art. OE37781	Art. OE37782
Compatible fluids	Oil and allied products	Oil and allied products	Oil and allied products
Body's material	Aluminium	Aluminium	Aluminium
Gear's material	POM	POM	POM
Inlet	F 1/2" BSP	F 3/4" BSP	F 1" + Flange
Outlet	F 1/2" BSP	F 3/4" BSP	F 1" + Flange
Delivery	1 - 35 l/min	1 - 70 l/min	2 - 100 l/min
Max operating pressure	70 bar	70 bar	70 bar
Burst pressure	200 bar	200 bar	200 bar
Accuracy	± 0,3 %	± 0,3 %	± 0,3 %
Net weight	0,485 kg	0,790 kg	1,100 kg
Packing	N°1 - m ³ 0,0015	N°1 - m ³ 0,0018	N°1 - m ³ 0,005
Gross weight	0,85 kg	1 kg	1,35 kg
Dimensions (A - B - C)	94 - 90 - 55 mm	94 - 91 - 77 mm	109 - 91 - 99 mm

TECHNICAL FEATURES

Sealed battery compartment assures continuous electronic contact in rugged working conditions

Aluminium body with special coating suitable also for antifreeze and windshield washing fluid

Robotically welded electronics board equipped with a wide LCD screen

The display is welded permanently on the electronic card

Double layer protective cover provides an air tight seal with the aluminium body

The use of 4 magnets provides superior control and precision measurement

A ribbon wire connection between the buttons and the electronic board provide superior connectivity

Raised buttons on the membrane produce an improved operational feel

Meter uses standard "off the shelf" two 1.5 v AAA batteries

Oval gears made of POM or PVDF are highly resistant to fatigue and offer excellent chemical resistance

Flow rate **90** l/min

Flow rate **120** l/min

Flow rate **40** l/min

OVERALL DIMENSIONS

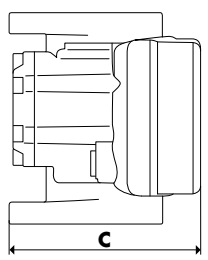
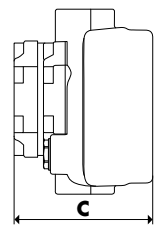
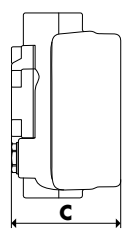
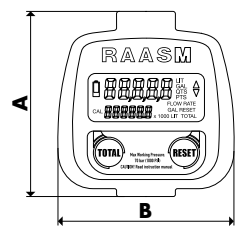

for **DIESEL FUEL**

for **DIESEL FUEL**

for **ANTIFREEZE** and **WINDSHIELD WASHING LIQUID**

Art. **OE33710**

Art. **OE33711**

Art. **OE33785**

Diesel fuel	Diesel fuel	Antifreeze and windshield washing liquid
Aluminium	Aluminium	Aluminium Zancofuso®
POM	POM	PVDF
F 3/4" BSP	F 1" + Flange	F 1/2" BSP
F 3/4" BSP	F 1" + Flange	F 1/2" BSP
1 - 90 l/min	2 - 120 l/min	1 - 40 l/min
70 bar	70 bar	70 bar
200 bar	200 bar	200 bar
± 0,3 %	± 0,3 %	± 0,5 %
0,790 kg	1,100 kg	0,485 kg
N°1 - m³ 0,0018	N°1 - m³ 0,005	N°1 - m³ 0,0015
1 kg	1,35 kg	0,85 kg
94 - 91 - 77 mm	109 - 91 - 99 mm	94 - 90 - 55 mm

PERFORMANCE

- Precision ± 0,3 %
- Repeatability 0,2 %
- Pressure loss < 0,5 bars at max flow rate
- Temperature ΔT -10° +60°C (-14° +140° F)

The display shows simple and intuitive information to allow easy use



Battery low level indicator

5 digit resettable totalizer

6 digit non resettable totalizer

Total may be multiplied by 10 - x 100 - x 1000

Unit: Litre - Gallon - Pint - Quarter

FLOW RATE indication

TOTAL or RESET TOTAL

Total-Unit: Litre - Gallon

The pulser meter is used to measure fluids and to transmit data. It is usually installed on centralized lubrication system to control and manage delivery of fluids.

Flow rate **35** l/min

Flow rate **70** l/min

Flow rate **100** l/min



for **OIL AND ALLIED PRODUCTS**

for **OIL AND ALLIED PRODUCTS**

for **OIL AND ALLIED PRODUCTS**

Not type-approved for public use

Article	Art. 0E39610	Art. 0E39613	Art. 0E39615
Compatible fluids	Oil and allied products	Oil and allied products	Oil and allied products
Body's material	Aluminium	Aluminium	Aluminium
Gear's material	POM	POM	POM
Inlet	F 1/2" BSP	F 3/4" BSP	F 1" + Flange
Outlet	F 1/2" BSP	F 3/4" BSP	F 1" + Flange
Delivery	1 - 35 l/min	1 - 70 l/min	2 - 100 l/min
Max operating pressure	70 bar	70 bar	70 bar
Burst pressure	200 bar	200 bar	200 bar
Accuracy	± 0,3 %	± 0,3 %	± 0,3 %
Pulser per liter	842	423	282
Max voltage	120V (200 Vdc Max)	120V (200 Vdc Max)	120V (200 Vdc Max)
Amperage	0,5 A	0,5 A	0,5 A
Power	10 W	10 W	10 W
Net weight	0,485 kg	0,790 kg	1,100 kg
Packing	N°1 - m ³ 0,0015	N°1 - m ³ 0,0018	N°1 - m ³ 0,005
Gross weight	0,85 kg	1 kg	1,35 kg
Dimensions (A - B - C)	94 - 90 - 55 mm	94 - 91 - 77 mm	109 - 91 - 99 mm

TECHNICAL FEATURES

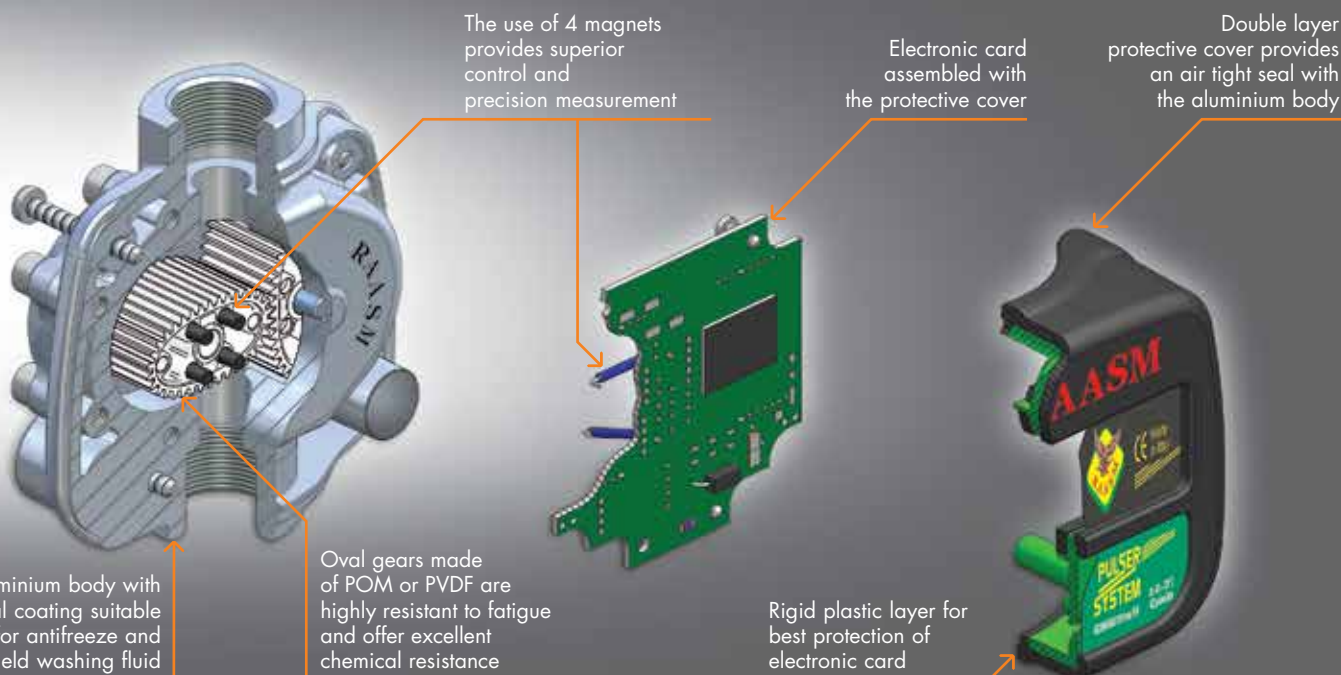

Flow rate **90** l/min

Flow rate **120** l/min

Flow rate **40** l/min



for **DIESEL FUEL**

for **DIESEL FUEL**

for **ANTIFREEZE** and
WINDSHIELD WASHING LIQUID

Art. **OE39614**

Art. **OE39616**

Art. **OE39611**

Diesel fuel	Diesel fuel	Antifreeze and windshield washing liquid
Aluminium	Aluminium	Aluminium Zancofuso®
POM	POM	PVDF
F 3/4" BSP	F 1" + Flange	F 1/2" BSP
F 3/4" BSP	F 1" + Flange	F 1/2" BSP
1 - 90 l/min	2 - 120 l/min	1 - 40 l/min
70 bar	70 bar	70 bar
200 bar	200 bar	200 bar
± 0,3 %	± 0,3 %	± 0,5 %
412	275	806
120V (200 Vdc Max)	120V (200 Vdc Max)	120V (200 Vdc Max)
0,5 A	0,5 A	0,5 A
10 W	10 W	10 W
0,790 kg	1,100 kg	0,485 kg
N°1 - m ³ 0,0018	N°1 - m ³ 0,005	N°1 - m ³ 0,0015
1 kg	1,35 kg	0,85 kg
94 - 91 - 77 mm	109 - 91 - 99 mm	94 - 90 - 55 mm

OVERALL DIMENSIONS

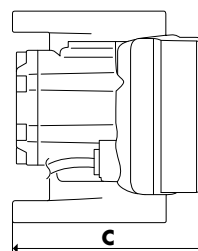
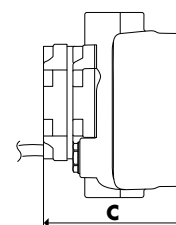
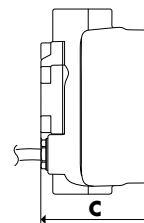
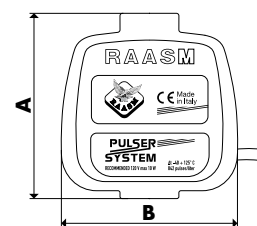

PERFORMANCE

- Precision $\pm 0,3 \%$
- Repeatability $\pm 0,2 \%$
- Voltage max 120 V 10W max
- Max amperage 0,5 A max
- Temperature $\Delta T -20^{\circ} +70^{\circ}C (-14^{\circ} +158^{\circ} F)$
- Length of the wire 1,5 m
- Kind of signal: clean contact (Reed switch)
- 2 chnnels (in quadrature)





ideal for industry



Meter with oil valve and nozzle



OUR AIMS

The use of the best Technical and Project Skills in order to offer to the Customers, everywhere all over the world, Excellence Products only.

www.ecodora.com
info@ecodora.com



Meters mounted on line

Meter mounted on pump outlet



Single valve pulser meter connected with solenoid valve to be used with FCS system



Remote display for pulse meter





All rights reserved to Ecodora s.r.l.

Ecodora S.r.l.
Vicenza - Italy
tel. +39 0424 570891
fax +39 0424 571354
www.ecodora.com
info@ecodora.com